

ROLLER TEAM KRONOS 274 TL, 170 hp

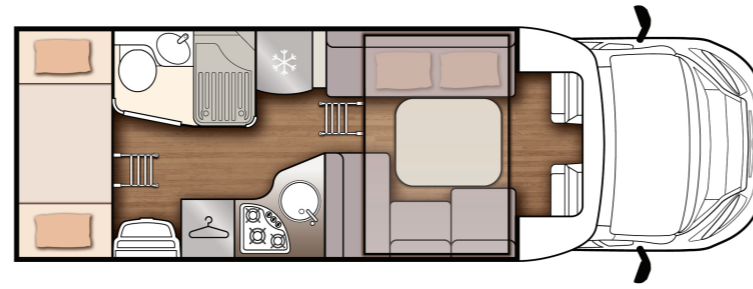

Paigaldatud lisavarustus

EST:

Kunstnahk istmekatted "Satin"

Pakett Ford "LOW PROFILE" (170 hp mootor, kvaliteetsed esituled ja kurvituled, udutuled, lukustatav kindalaegas, "Trend" armatuurlaua disain, kerega sama värvi esistange ja küljeliistud, elektriline esiklaasi jääsulataja/soojendus, vihmaseensoriga automatiseeritud kojamehed, päevatulede automaatne lülitus, kokkupõrkeohu eest hoiatav abikaamera, sõiduraja hoiatamise ja hoidmise abisüsteem, rehvirõhu andur, elamuosa üks aknaga/-kesklukustusega/-kahe lukustuspunktiga, 120W päikesepaneel, tagurduskaamera ja monitor, kabiiniosa pimenduskardinad

Pakett "Select" (automaatkäigukast ja "SELECT" kleebis)

Talvepakett (isoleeritud elamuosa trepiaste, isoleeritud väline äravoolutorustik, isoleeritud ja 12V elektrilise küttega hallvepaak)

Truma Combi 6 EH kütteseade (1800W elekter ja 6000W gaas)

Isofix laste turvaisemete kinnitused

Elamuosa aku 95 Ah AGM Varta

Laadimisvõimendi 40 Ah, elamuosa akude efektiivsemaks ja kiiremaks laadimiseks

Ford originaalraadio (sinihammas, USB, raadio)

ENG:

UPHOLSTERY SATIN

PACK FORD LOW PROFILE: 170 HP, HIGH SERIES HEADLIGHTS WITH STATIC CORNERING LIGHTS, FOG LIGHTS, GLOVE BOX WITH LOCK, TREND" INTERIOR TRIM AND DASHBOARD, BUMPERS AND SIDE MOULDINGS IN MATCHING BODY COLOUR, ELECTRIC WINDSCREEN DEFROSTER, AUTOMATIC WINDSCREEN WIPERS WITH RAIN SENSOR, AUTOMATIC HEADLIGHTS, PRE-COLLISION ASSIST CAMERA, LANE KEEPING WARNING AND ASSISTANCE, TPMS - TYRE PRESSURE MONITORING SENSOR,

TWO-PART DOOR WITH WINDOW AND CENTRAL LOCKING, SOLAR PANEL, SINGLE REAR-VIEW CAMERA, PLEATED BLIND
PACK SELECT (AUTOMATIC GEAR, SELECT STICKER)
WINTER PACK (insulated step, insulated, heated pipes)
TRUMA COMBI 6 EH (electric + gas heater)
ISOFIX
Living unit battery 95 Ah AGM Varta
Lade booster 40 Ah
FORD ORIGINAL STEREO (RADIO, USB, BT-handsfree)

SÕIDUKI ANDMED

YEAR:	2024
ODOMETER READING:	ca 5 km
FRAME:	FORD TRANSIT
BRAND:	ROLLER TEAM
MODEL:	KRONOS 274 TL
NO. OF SEATS:	6
NO. OF BERTHS:	6
BED IN THE BACK:	Bunk-bed
REQUIRED DRIVING LICENSE:	Category B
MOTOR TYPE:	MULTIJET II, (2,3 L) EURO 6D DIESEL ENGINE
ENGINE POWER:	125 kW (170 hj)
TRANSMISSION:	Automatic transmission
WHEELS:	16" STEEL WHEELS WITH TRIMS
TYRES:	235 / 70 / 16 CAMPERI REHVID
LENGTH/HEIGHT/WIDTH:	7,45 m / 2,95 m / 2,35 m
WATER TANK:	120 ltr
SEWAGE TANK:	120 ltr
HEATING AND HOT WATER:	Truma Combi 6 EH (6000 W + 1800 W) gas + electric heater / electric heater

HIND:

~~82,940€~~

78,990€

Hind sisaldab käibemaksu 22%

Image not found or type unknown

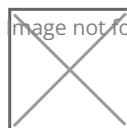

MOTORHOME.ee
MATKAAUTODE MÜÜK JA RENT