

Mobilvetta
M

2024 RANGE

Mobilvetta GUIDELINES

Mobilvetta continues its commitment to comfort and excellence with a 2024 range that is *even more...*

01

... *premium*

New premium **technology and equipment.**

02

... *exciting*

Improved finishing, attention to details, high value materials, perfection, **consistency and equipment.**

03

... *comfortable*

Better habitability with an improved layout, more accessibility and **user comfort.**

04

... *lightweight*

Safety, technology and **optimised weight** for a customisable product designed for the user's lifestyle.

MOBILVETTA 2024



K-YACHT TEKNO LINE

UPGRADE



KEA I

IMPROVEMENT



KROSSER

UPGRADE



KEA P

IMPROVEMENT



ADMIRAL

UPGRADE

MOBILVETTA 2024 PLAN



EURO 6-D

2.2 MULTIJET3 - 140 HP

MANUAL

6 METRES

7 METRES

MOTORHOME



K-Yacht Tekno Line



Kea I



K-YACHT TEKNO LINE 64



KEA I64



KEA I85



K-YACHT TEKNO LINE 86



KEA I86



K-YACHT TEKNO LINE 90



KEA I90

SEMI-MOTORHOME

With/without elevating bed



Krosser



Kea P



KROSSER 64



KEA P64



KEA P85

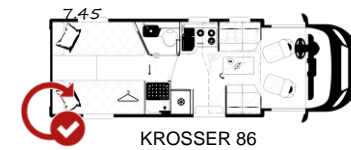

KROSSER 86

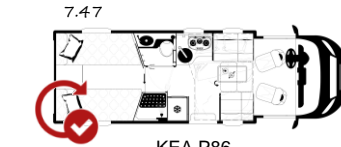

KEA P86

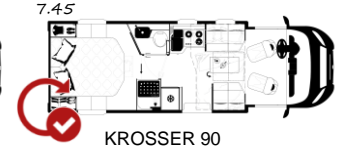

KROSSER 90



KEA P90

VAN



Admiral



K 5.1



K 6.3



K 6.5



KEA I71



KEA P71



N *Mobilvetta* MOTORCARAVAN



COMMON NEW FEATURES

COMMON NEW FEATURES

New functions and equipment for a better user experience



TRUMA iNET X SYSTEM

Control your utilities remotely
with your smartphone



Compressor refrigerator

Improved performance
More autonomy



Double battery system

Integrated system
with more autonomy



On-board TEKNiBox

Userfriendly daily
maintenance

COMMON NEW FEATURES

Truma iNET X System



**Start smart.
Be smart.
Stay smart.**



*K-Yacht Tekno Line and Krosser standard
Kea option*

✓ The intelligent, comfortable and safe vehicle

The iNetX system gives you total control over all your motorhome's devices and utilities (climate, hot water and other functions), with a central control panel which enables you to monitor all status indicators in real time.

✓ Easy to use and customisable

User friendly control panel with colour touchscreen display.
Can also be used while the motorhome is driving.
Advanced control with your smartphone: control the device remotely with the Truma iNet X smartphone app (up to 10 metres from the vehicle).
You can even customise the app interface to suit your personal requirements.

✓ Reliable and upgradable

We are continually updating our systems to improve their quality.
The system can be upgraded with new functions and additional features, even after installation.
Troubleshooting assistance with precise descriptions of faults and practical suggestions on how to resolve them.

COMMON NEW FEATURES

Compressor refrigerator





K-Yacht Tekno Line and Krosser standard
Kea option (158 litres) *

THE LARGEST REFRIGERATOR ON THE MARKET

174 Litres

- Cooler and faster 

The refrigerator quickly cools down to the desired temperature with the FAST start option.
- Unaffected by the heat. 

Hot weather does not affect its performance.
- You choose how you use it. 

It has separate functions to activate the refrigerator and freezer, turning the latter into a "cool" compartment
- Smart energy consumption. 

It works like the one at home, meaning the compressor runs for a few minutes every 15-20 minutes. This results in considerable energy savings: the system works only 10-20 minutes every hour and not 24 hours a day!

* K-YACHT TEKNO LINE and KROSSER: Model Thetford T2175 - KEA Model Thetford T2160

COMMON NEW FEATURES

Double battery system

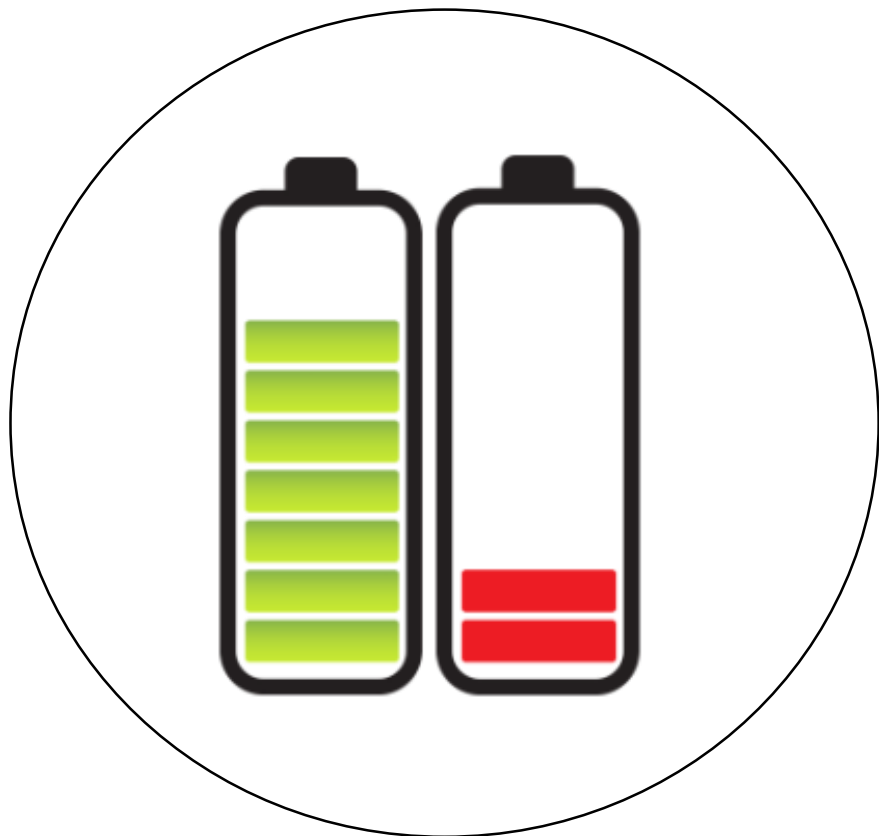

✓ When your energy needs increase!

Automatic changeover switch for separate control of two utility batteries, even of different types and charge capacities, thus improving the system's efficiency and keeping it in good condition.

✓ Battery disconnecter

The battery disconnecter, automatic or manual, prevents the battery draining below its specified minimum charge, which can often happen in normal use or due to small continuous charges when in storage.

✓ With microcontroller

The microcontroller continuously monitors the status of the two batteries and their input and output voltages and current.
Battery management up to 2000W input/output

K-Yacht Tekno Line, Krosser and Kea standard

COMMON NEW FEATURES

On-board TEKNIbox



For daily maintenance

Easy access to the most important controls

All electrical utilities in a single location

USER FRIENDLY

K-Yacht Tekno Line, Krosser and Kea standard

COMMON NEW FEATURES

Restyled compact bathroom



K-Yacht Tekno Line 64
Krosser 64
Kea 64



New waterproof curtain

Sliding shower curtain with rail.



Improved locking system with mechanical push-lock

Locks the wall in place in the toilet position. The closure system is now magnetic. In the shower position, the wall is locked in place by a cord with buttons concealed behind the door.





2024 RANGES



K-YACHT TEKNO LINE

Range plan

6.99

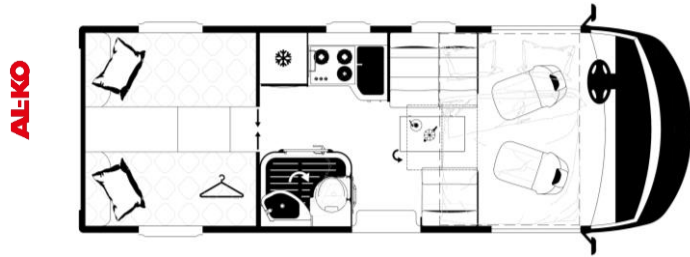

K-YACHT TEKNO LINE 64

7.50



K-YACHT TEKNO LINE 86

7.50



K-YACHT TEKNO LINE 90

NEW

**NEW SHOWER BOX POSITION,
REDESIGNED awning OF SHOWER BOX**



Fiat Ducato
Euro 6 final
2.2 Multijet
140 HP

K-YACHT TEKNO LINE

Shower BOX

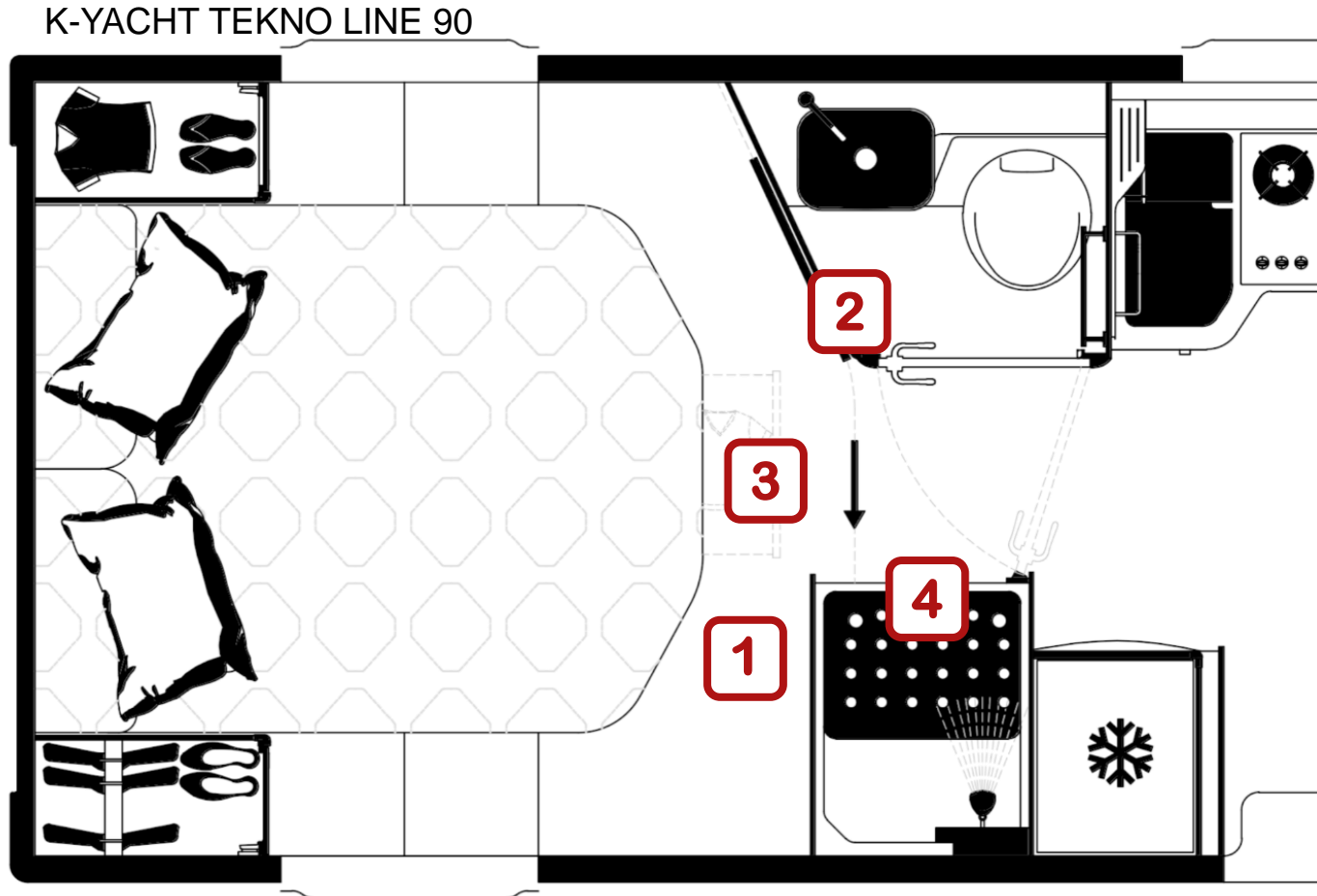

Better ⁰¹ clearance

around the central bed,
approx. 30 cm.

Sliding door ⁰²

with single panel.

More space ⁰³

to move around the bed when
with the sliding door is closed.

Shower door ⁰⁴

easier to use.

The box is now equipped with a rigid side wall.

K-YACHT TEKNO LINE

Shower box

K-YACHT TEKNO LINE 86

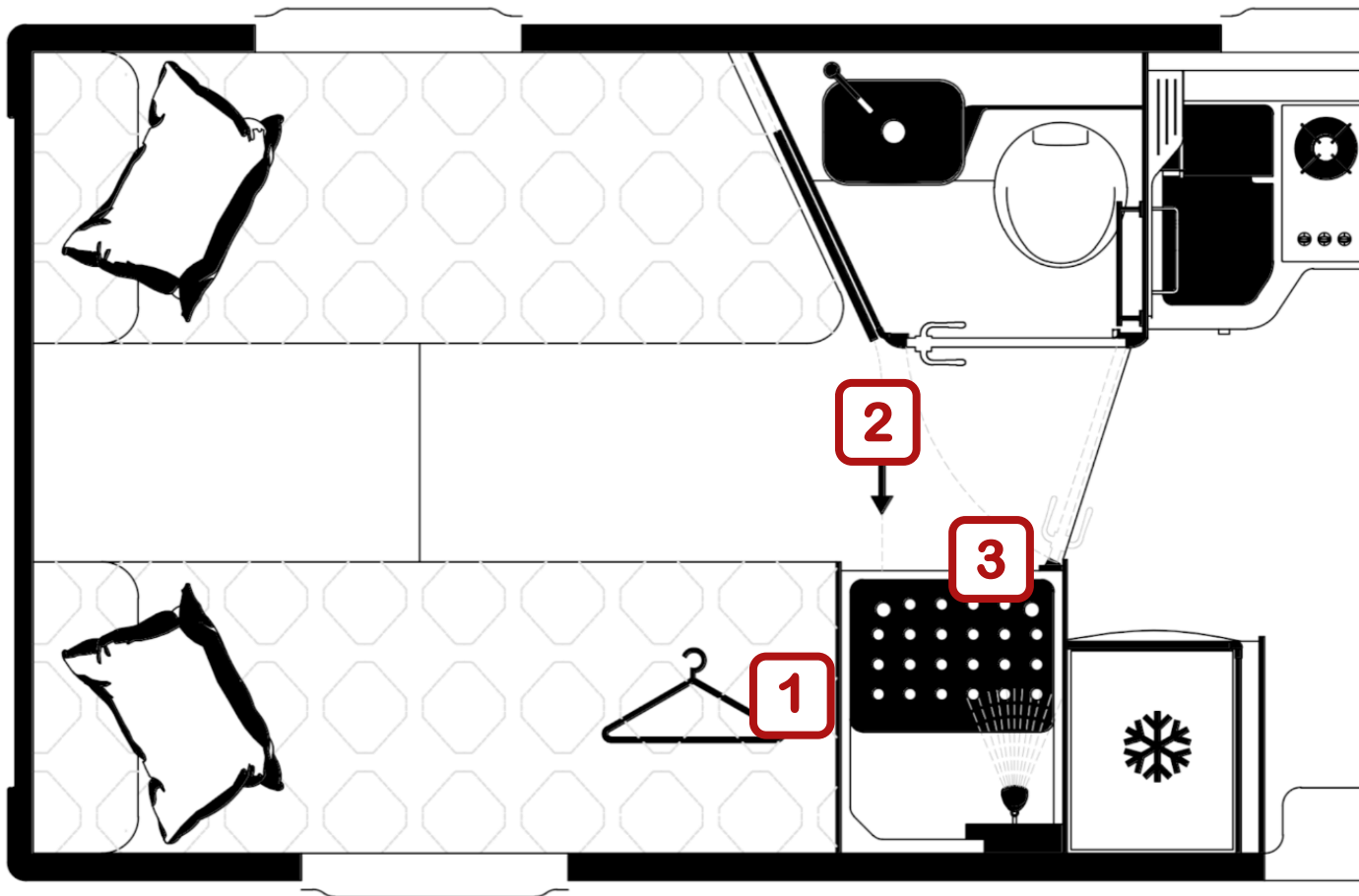

+ 10 cm

longer bed
on the passenger side.

Sliding door

single panel.

Shower door

easier to use.

K-YACHT TEKNO LINE

Changes to the interiors

HIGH
PERFORMANCE
COMFORT AND
HABITABILITY



KITCHEN



LIVING



BEDROOM



SHOWER

LIVING AREA



1 *Harmonized colors*

2 *Finishings and quality*

The furniture have improved finishings and they appear more solid thanks to new 2mm surface layer



Kitchen AREA



Exclusive pleasure

The coffee machine compartment is integrated into the paper roll holder.



Toilet AREA



Light and air

The corridor skylight has been moved into the shower area and equipped with a handy spot light.

PASSAGE from the living to the sleeping area



Update photo



Single-level sleeping area

toilet and sleeping area are now on the same level, thanks to an extension of the raised rear platform.



Sleeping AREA

1 Access to the garage.

thanks to the door between the storage compartment and the sleeping area, openable from inside (mod. 64 - 86)

2 Maxi bed, available whenever you need it

A new sliding mechanism allows you to quickly pull out the bed extension, making a maxi bed out of the two twin beds (mod. 64 -86) .

3 Better access to the wardrobe

on the passenger side, thanks to the sliding clothes hanger. The wardrobe doors are now equipped with a soft closing mechanism.

K-YACHT TEKNO LINE

Exterior changes

- ✓ More distinctive design
- ✓ Optimised and reduced weight



- 1 Improved habitation door
- 2 Built-in handles
- 3 New flat windows
- 4 ABS skirts **NEW**
- 5 Fiberglass side panels **NEW**
- 6 Fog lights as standard equipment **NEW**

Optimised and reduced weight!

1 Fiberglass walls

Hail proof.
More robust and longer lasting.

2 ABS skirts

In family feeling with Mobilvetta design

late photo



BUILT-IN HANDLES

✓ *Distinctive design*

Elegant exterior style with completely built-in handles

✓ *On all doors*

Including garage and side storage compartments.

✓ *Quality*

Completely waterproof.
Fully protected against corrosion.





K-YACHT TEKNO LINE

Exterior changes

flat WINDOWS



Distinctive design

For more elegant external style

Minimal external protrusions

K-YACHT TEKNO LINE

Changes in the garage

Even easier to use

1

Anchoring systems

6 tie-down rings
(+2 central anchor points)

2

Easier to clean

With 2 floor drain grilles

3

Easier to load

The height has been increased to 120 cm in the whole garage area (also in layout with central bed (mod. 90)).



UPHOLSTERY

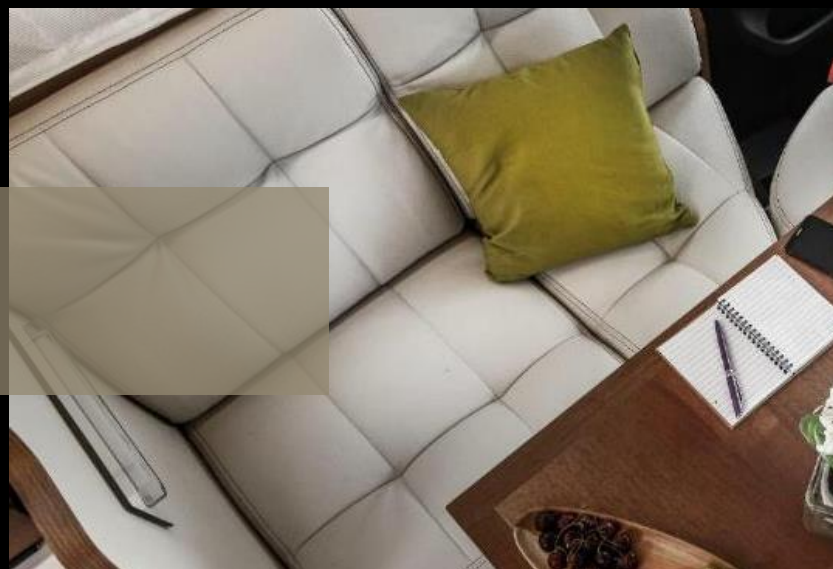

PRESTIGE

Standard, eco-leather.



PRESTIGE BROWN

Optional, eco-leather and fabrics.

K-YACHT TEKNO LINE

Standard equipment

CHASSIS

ENGINE	140 HP
AL-KO CHASSIS	STANDARD
AUTOMATIC CLIMATE CONTROL SYSTEM	NEW STANDARD
DRIVER + PASSENGER AIR BAG	STANDARD
TRACTION +/- HILL DESCENT	STANDARD
CRUISE CONTROL	STANDARD
16" ALLOY WHEEL RIMS	STANDARD
DAY RUNNING LED LIGHTS + FOG LIGHTS	STANDARD
STEERING WHEEL CONTROLS	NEW STANDARD
BUS-TYPE REAR-VIEW MIRRORS	STANDARD
TPMS	NEW STANDARD
LEATHER STEERING WHEEL AND GEARBOX	STANDARD
FULL DIGITAL CLUSTER AND TEKNO DASHBOARD	NEW STANDARD
FULL LED FRONT LIGHTS	NEW STANDARD

TECHNOLOGY

I-NET X	STANDARD
USER-FRIENDLY TEKNI-BOX SYSTEM	STANDARD
DOUBLE BATTERY MANAGEMENT SYSTEM	STANDARD
OPEN DOOR SENSOR	STANDARD

LIVING UNIT

COMPRESSOR FRIDGE	NEW 174 L
KITCHEN TOP	3 BURNERS
WOOD DOORS FOR BATHROOM/SLEEPING AREA SEPARATION	STANDARD
PLEATED BLIND	STANDARD
LIVING UNIT SPEAKERS	STANDARD
FLOOR HATCH	STANDARD
TV HOLDER WITH EXTENSIBLE ARM	STANDARD
WI-FI CONNECTION READY	STANDARD
REINFORCED ABS SHOWER BASE + PLATFORM	STANDARD
HEATER	TRUMA COMBI 6
SOFT TOUCH WALLS AND ROOF (kitchen and toilet excluded)	STANDARD
PASS-THROUGH DOUBLE FLOOR	STANDARD
FOLDING TOP TABLE	STANDARD
CHAISE-LONGUE PASSENGER SEAT	STANDARD
TWIN BEDS EXTENSION (64, 86)	STANDARD

EXTERIORS

2-POINT XL DOOR + WINDOW	STANDARD
HABITATION DOOR FLYSCREEN	STANDARD
CENTRAL LOCKING	STANDARD
EXTERIOR LIGHT	STANDARD
SKY DOME	STANDARD
REAR BED ROOFLIGHT	70 x 50
ABS SKIRTS	STANDARD
ABS REAR COLUMNS LED HEADLIGHTS	STANDARD
STORAGE COMPARTMENT BUILT-IN HANDLES	STANDARD
HEATED TANK	STANDARD
OVERSIZED TANKS (clear/grey water)	145/135 litres
INTEGRATED AND INSULATED STEP	STANDARD
OPENABLE SKIRT WITH STORAGE COMPARTMENT	STANDARD
EXTERNAL POWER AND TV SOCKET	STANDARD
EXTERNAL GAS SOCKET	STANDARD
EXTERNAL WATER SOCKET	STANDARD



KROSSER

Range plan

Insert updated layouts

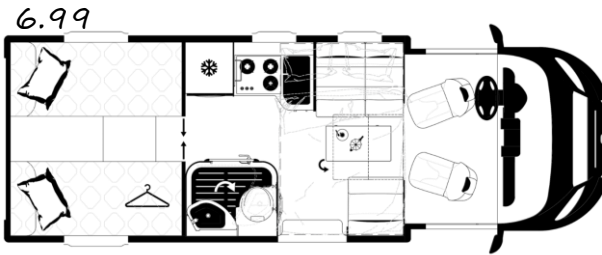

KROSSER 64

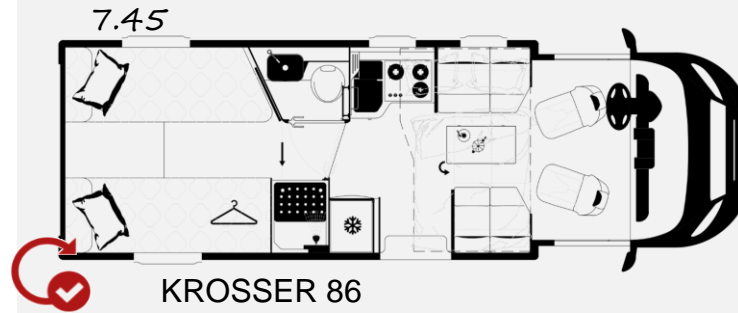

KROSSER 86

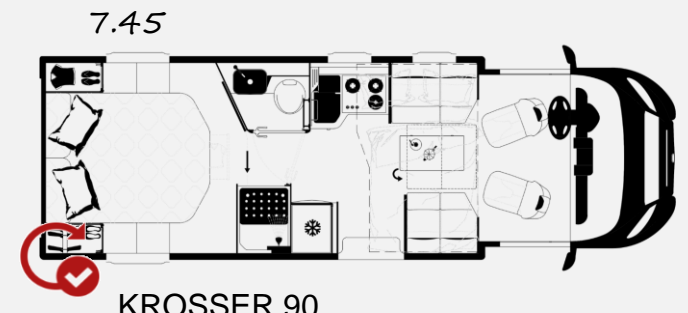

KROSSER 90

NEW

**NEW SHOWER BOX POSITION,
REDESIGNED awning OF SHOWER BOX.
NEW KITCHEN.**



Fiat Ducato
Euro 6 final
2.2 Multijet
140 HP

New shower box position

KROSSER 90

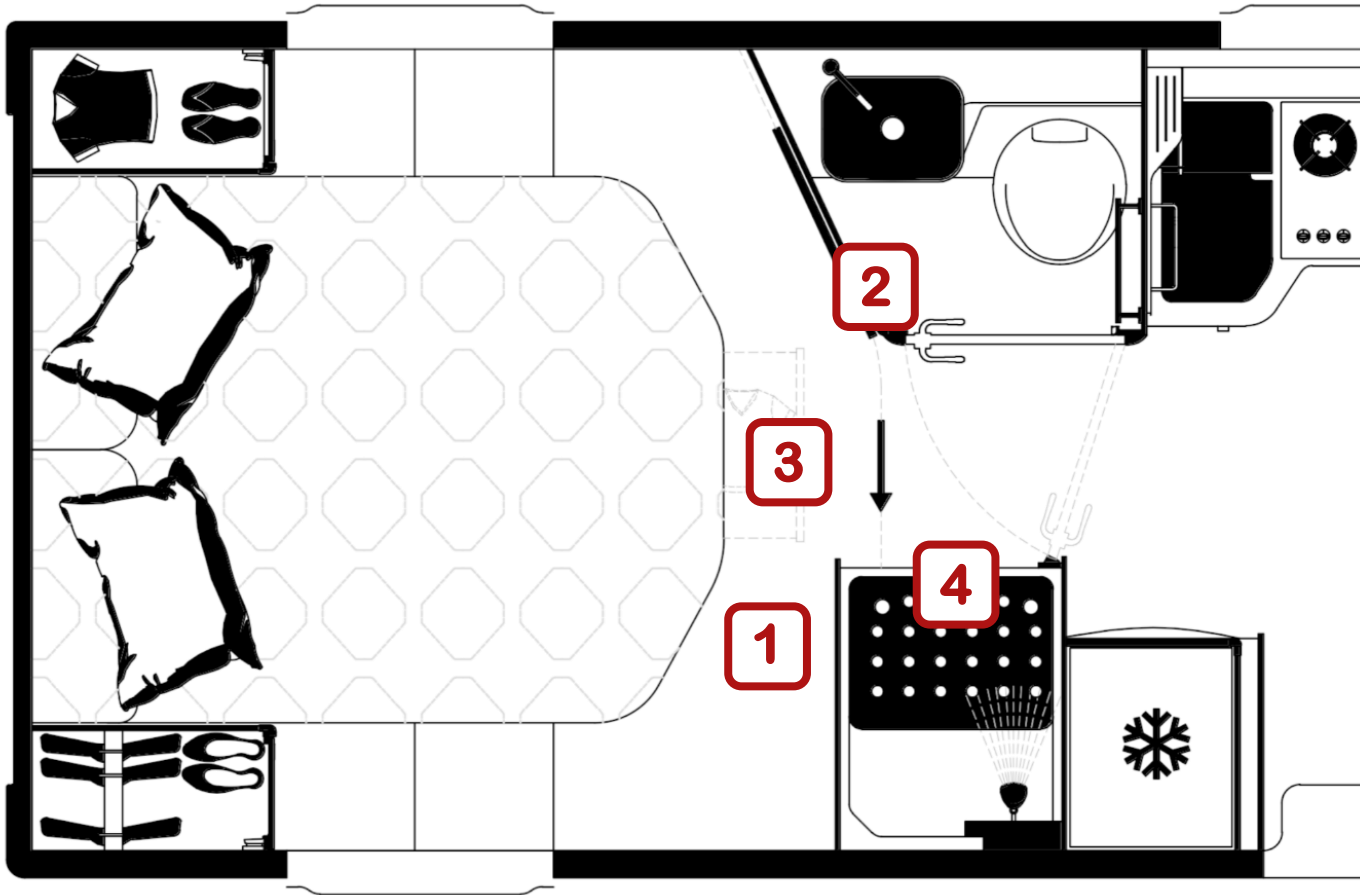

Better **01** *clearance*

around the central bed,
30 cm. approx

Sliding door **02**

single panel.

More space **03**

for moving around the bed with
sliding door closed.

Shower door **04**

easier to use.

The box has a closed side wall.

KROSSER

New shower box position

KROSSER 86

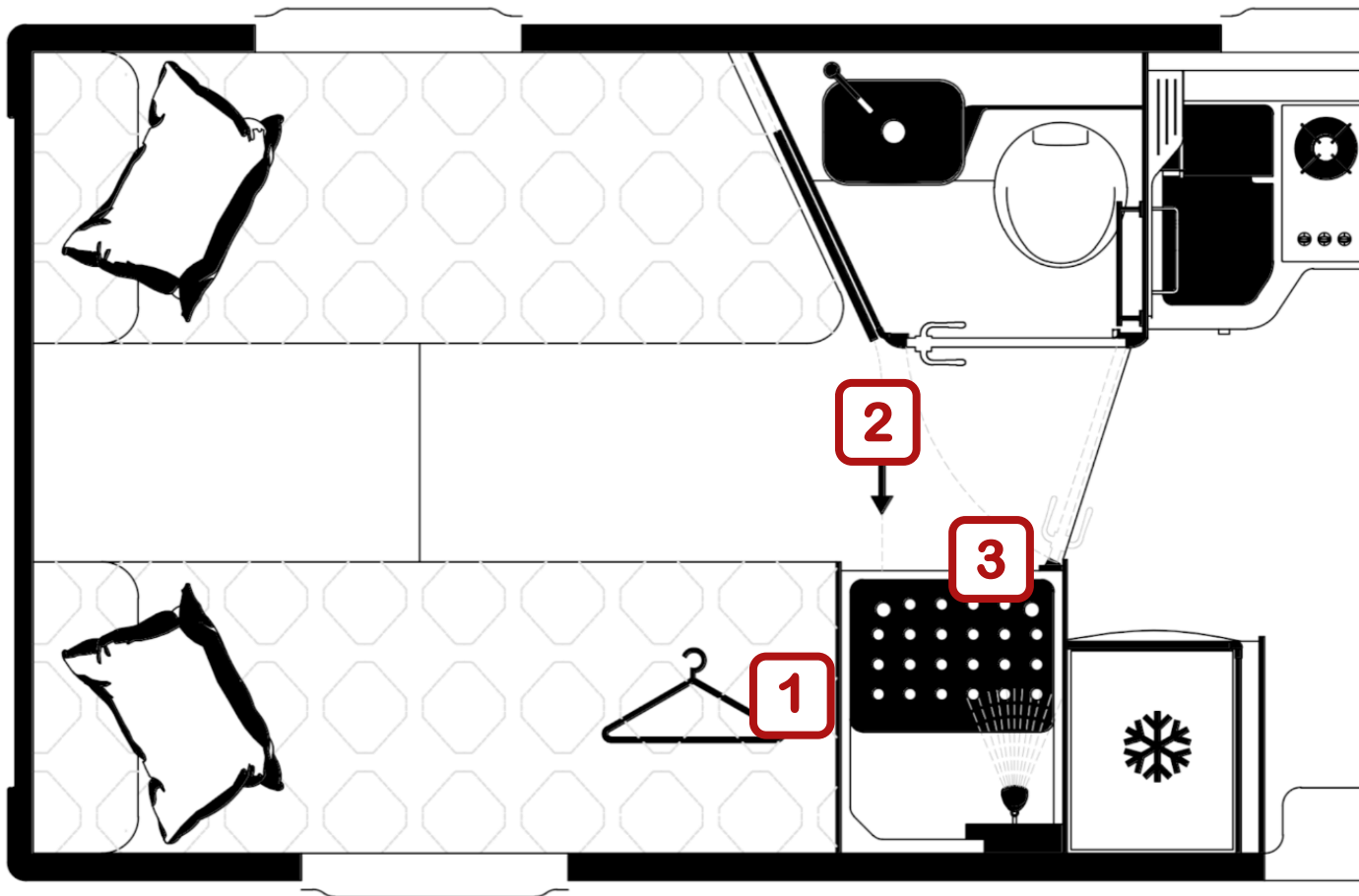

+ 10 cm

length for passenger's
side bed.

Sliding door

single panel.

Shower door

easier to use.

KROSSER

Interior changes



**HIGH
PERFORMANCE
FOR COMFORT AND
HABITABILITY**



KROSSER

Changes to the interiors



re photo



Kitchen AREA

- 1** *New kitchen,*
Derived from the K-Yacht Tekno Line, **quality and adaptability.** Same functionality.
- 2** *Exclusive pleasure*
The coffee machine compartment is integrated into the paper roll holder.

LIVING AREA



Elegant Entrance

Newly designed entrance wall. Redesigned volumes provide enough space for a 32" TV



Finishings and quality

The furniture have improved finishings and they appear more solid thanks to new 2mm surface layer

Toilet AREA



Light and air

The corridor skylight has been moved into the shower area and equipped with a handy spot light.

PASSAGE from the living to the sleeping area



Update photo

1



Single-level sleeping area

toilet and sleeping area are now on the same level, thanks to an extension of the raised rear platform.



SLEEPING AREA

1 Access to the garage.

thanks to the door between the storage compartment and the sleeping area, openable from inside (mod. 86)

2 Maxi bed, available whenever you need it

A new sliding mechanism allows you to quickly pull out the bed extension, making a maxi bed out of the two twin beds (mod. 64 -86)

3 Better access to the wardrobe on the passenger side, thanks to the sliding clothes hanger.

The wardrobe doors are now equipped with a soft closing mechanism.

KROSSER

Exterior Changes

- ✓ More distinctive design!
- ✓ Optimised and reduced weight!

- 1 Improved habitation door
- 2 Built-in handles
- 3 New flat windows
- 4 ABS skirts
- 5 Fog lights as standard equipment

NEW



UPDATE PHOTO

Optimised and reduced weight!



Update photo



ABS skirts

In family feeling with Mobilvetta design

BUILT-IN HANDLES

✓ *Distinctive design*

Elegant exterior style with completely built-in handles

✓ *On all doors*

Including garage and side storage compartments.

✓ *Quality*

Completely waterproof.
Fully protected against corrosion.





KROSSER

Exterior Changes

flat WINDOWS



Distinctive design

For more elegant external style

Minimal external protrusions

KROSSER

Changes in the garage

Easier to use

1

Anchoring systems

6 tie-down rings
(+2 central anchor points)

2

Easier to clean

With 2 floor drain grilles

3

Easier to load

The height has been increased to 120 cm in the whole garage area (also in layout with central bed (mod. 90)).

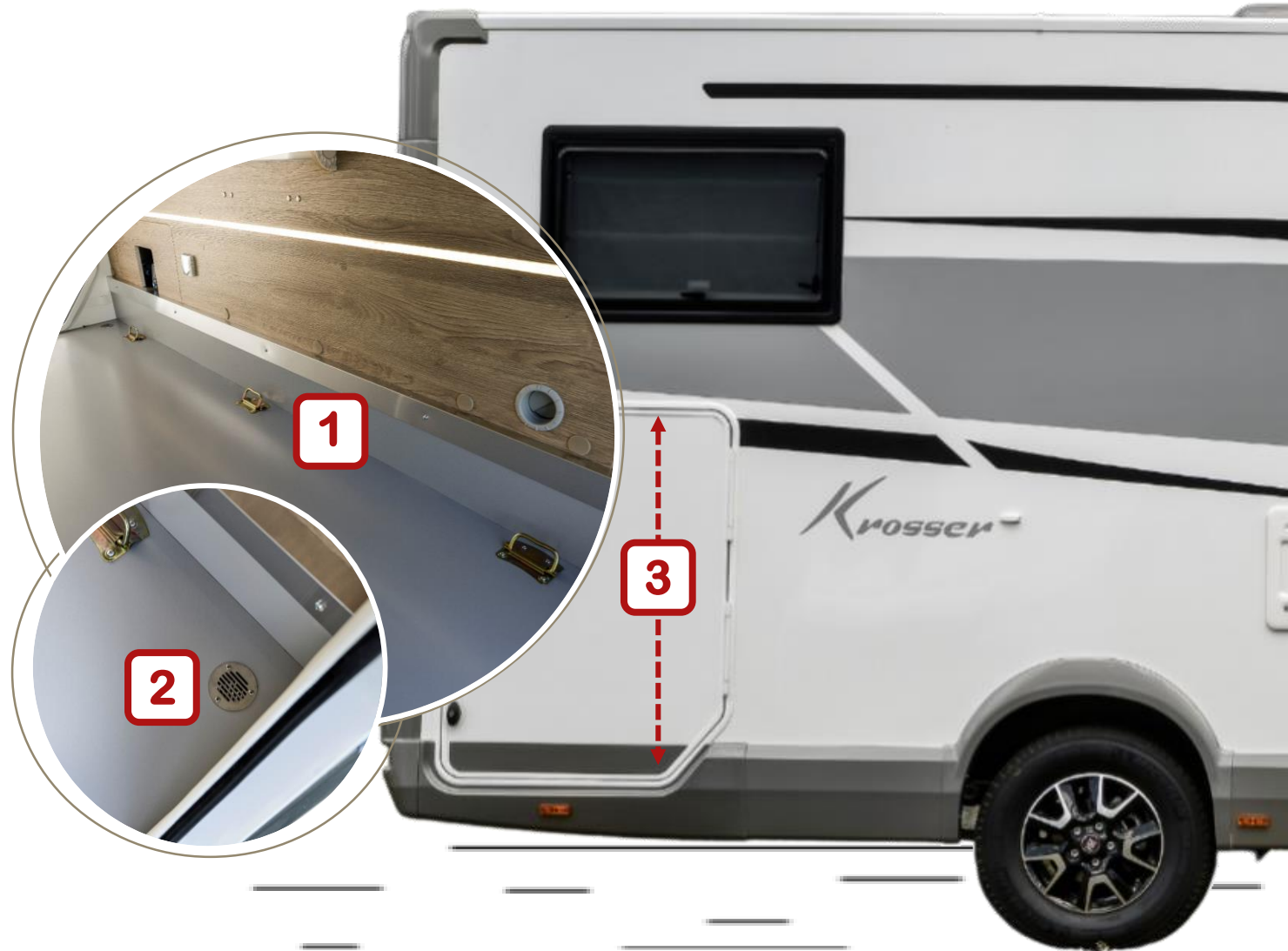

UPHOLSTERY

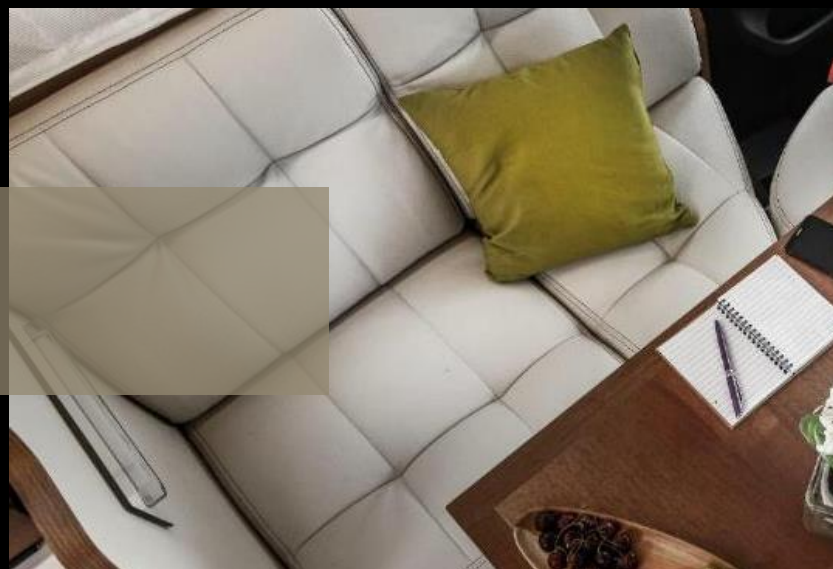

PRESTIGE

Standard, eco-leather.



PRESTIGE BROWN

Optional, eco-leather and fabrics.

KROSSER

Standard equipment

CHASSIS

POWER UNIT	140 HP
MANUAL CLIMATE CONTROL SYSTEM	STANDARD
DRIVER + PASSENGER AIR BAG	STANDARD
TRACTION +/- HILL DESCENT	STANDARD
CRUISE CONTROL	STANDARD
16" ALLOY WHEEL RIMS COMPOSITE SUSPENSION	STANDARD
BLACK RADIATOR GRILLE + SKID PLATE AND HEADLIGHTS	STANDARD
FOG LIGHTS NEW	STANDARD
STEERING WHEEL CONTROLS AND DAB ANTENNA	STANDARD

TECHNOLOGY

I-NET X	STANDARD
USER-FRIENDLY TEKNI-BOX SYSTEM	STANDARD
DOUBLE BATTERY MANAGEMENT SYSTEM	STANDARD
OPEN DOOR SENSOR	STANDARD

LIVING UNIT

COMPRESSOR FRIDGE	NEW 174 L
KITCHEN TOP	3 BURNERS
PARTITION DOORS IN WOOD FOR THE BATHROOM/SLEEPING AREA	STANDARD
PLEATED BLIND	STANDARD
LIVING UNIT SPEAKERS	STANDARD
FLOOR HATCH	STANDARD
TV HOLDER WITH EXTENSIBLE ARM	STANDARD
MAXI SLEEPING AREA WINDOWS	STANDARD
REINFORCED ABS SHOWER BASE + PLATFORM	STANDARD
HEATER	TRUMA COMBI 6
PASS-THROUGH DOUBLE FLOOR	STANDARD
SOFT TOUCH ROOF	STANDARD
FOLDING TOP TABLE	STANDARD
CHAISE LONGUE PASSENGER SEAT	STANDARD
TWIN BEDS EXTENSION (64, 86)	STANDARD

EXTERIORS

2 POINT XL DOOR + WINDOW	STANDARD
LIVING UNIT DOOR FLYSCREEN	STANDARD
CENTRAL LOCKING	STANDARD
EXTERIOR LIGHT	STANDARD
SKY DOME	STANDARD
REAR BED ROOFLIGHT	70 x 50
REAR BANDS AND COLUMNS	ABS
STORAGE COMPARTMENT BUILT-IN HANDLES	STANDARD
HEATED TANK	STANDARD
OVERSIZED TANKS (clear/grey water)	145/135 litres
INTEGRATED AND INSULATED STEP	STANDARD
OPENABLE SKIRT WITH MAXI-GARAGE	STANDARD
GARAGE LIGHTING	STANDARD
220 V GARAGE SOCKET	STANDARD



KEA I & KEA P

Range plan

6.99



KEA I 64

6.99



KEA P64

7.47

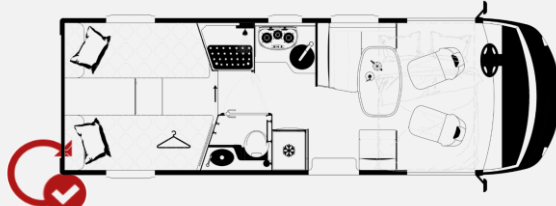

KEA I 85

7.47



KEA I 86

7.47



KEA I 90

7.47



KEA P85

7.47



KEA P86

7.47



KEA P90

NEW

NEW SHOWER BOX!



Fiat Ducato
Euro 6 final
2.2 Multijet
140 HP

New shower box position

KEA 90

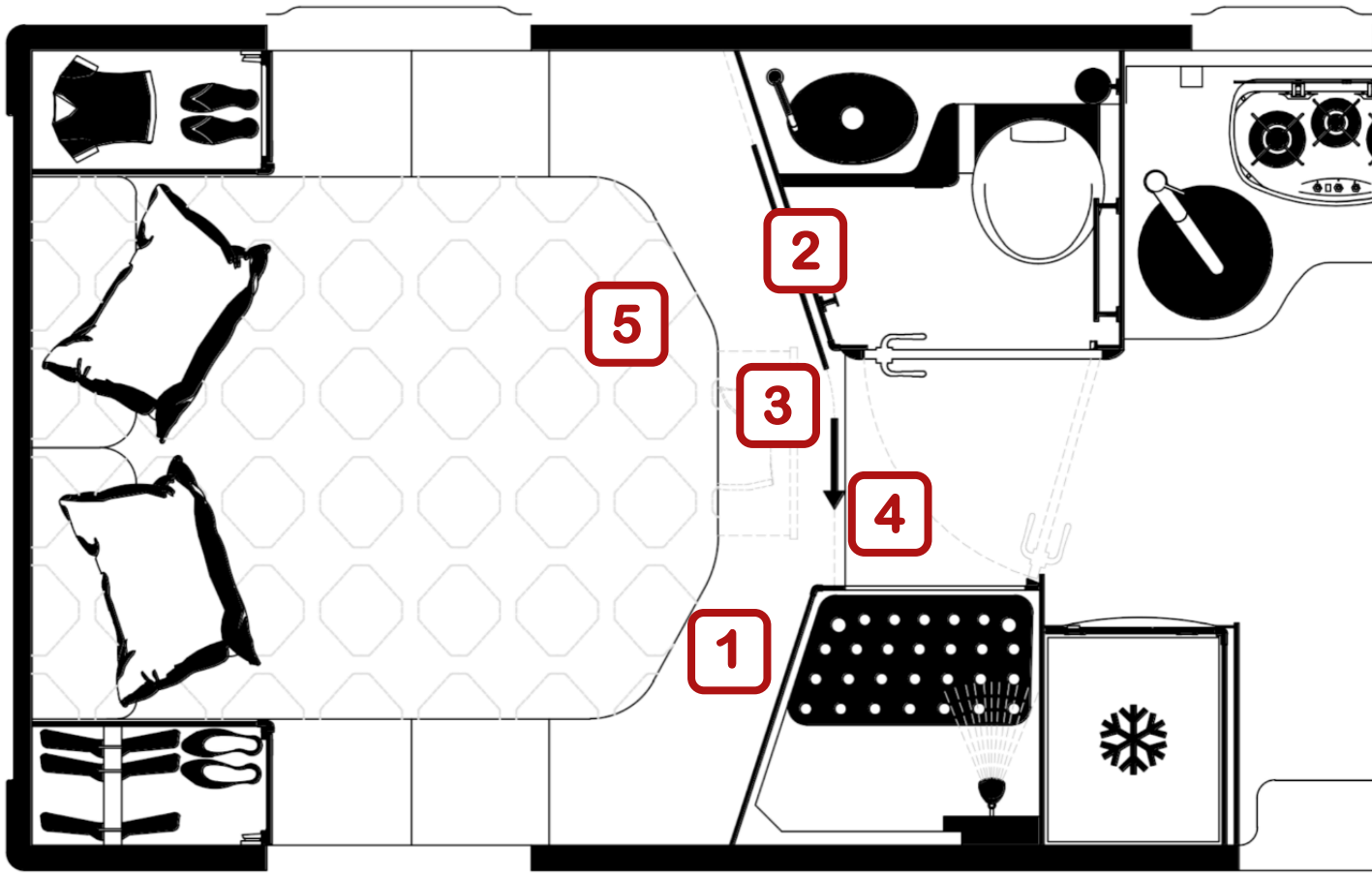

Better **01**

around the central bed.

Sliding **02** *door*

single panel.

More **03** *space*

for moving around the bed
with sliding door closed.

Shower **04** *door*

easier to use.

The box has a closed side wall.

Mattress **05**

The right shape for the
best comfort.

New shower box position

KEA 86

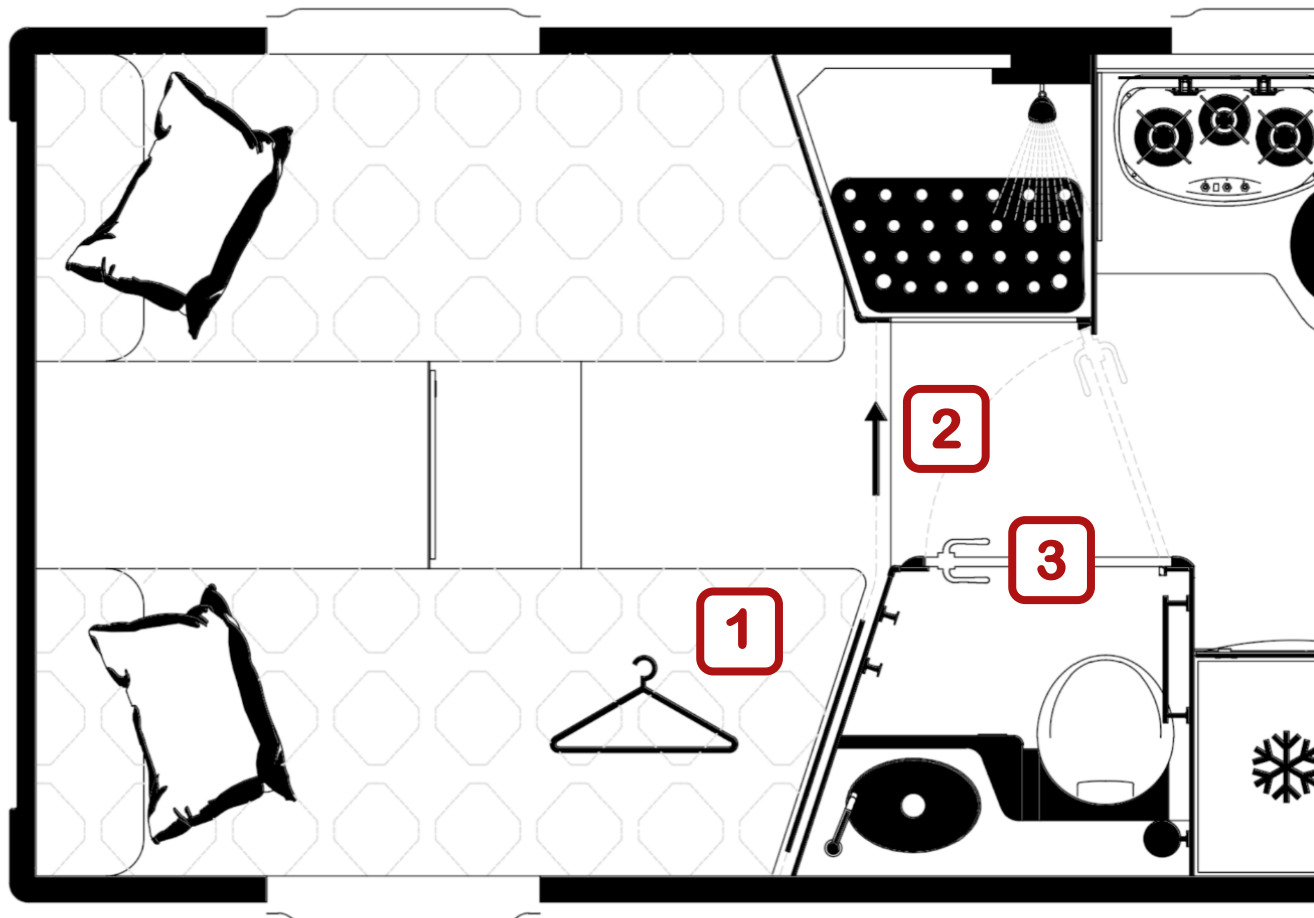

More comfortable

More foot space for the bed on the passenger's side.
New shape of mattresses.

“
Left side bed: 200,5x80 (↔ 198x80) cm
Right side bed: 205x80 (↔ 200x80) cm
”

Sliding door

single panel.

Shower door

easier to use.

KEA I & KEA P

Interior Changes

HIGH
PERFORMANCE
FOR COMFORT
AND
HABITABILITY



BEDROOM LIVING

late photo

Living AREA



1 *More seating space*

Larger side sofa (Kea I).

2 *Finishings and quality*

The furniture have improved finishings and they appear more solid thanks to new 2mm surface layer

Sleeping AREA



1 Access to the garage

thanks to the door between the storage compartment and sleeping area, openable from inside (mod. 86)

Maxi bed, available whenever you need it

A new sliding mechanism allows you to quickly pull out the bed extension, making a maxi bed out of the two twin beds (mod. 64 -86)

3 Better access to the wardrobe

on the passenger's side, thanks to the sliding clothes hanger. The wardrobe doors are now equipped with a soft closing mechanism.

KEA

Changes in the garage

Easier to use

1

Anchoring systems

6 tie-down rings
(+2 central anchor points)

2

Easier to clean

With 2 floor drain grilles



UPHOLSTERY



PRESTIGE

Standard, eco-leather and fabrics.



PRESTIGE BROWN

Optional, eco-leather.

KEA I & KEA P

Standard equipment

CHASSIS

POWER UNIT	140 HP
MANUAL CLIMATE CONTROL SYSTEM	STANDARD
DRIVER + PASSENGER AIR BAG	STANDARD
TRACTION +/- HILL DESCENT	STANDARD
CRUISE CONTROL	STANDARD
16" ALLOY WHEEL RIMS COMPOSITE SUSPENSION	STANDARD
BLACK RADIATOR GRILLE + SKID PLATE AND HEADLIGHTS - WHITE BUMPER	STANDARD
FOG LIGHTS NEW	STANDARD
LED DRLs (I VERSION)	STANDARD
STEERING WHEEL CONTROLS AND DAB ANTENNA	STANDARD

TECHNOLOGY

USER-FRIENDLY TEKNI-BOX SYSTEM	STANDARD
DOUBLE BATTERY MANAGEMENT SYSTEM	STANDARD

LIVING UNIT

TRIVALENT FRIDGE	145 L
KITCHEN TOP	3 BURNERS
PARTITION DOORS IN WOOD FOR THE BATHROOM/SLEEPING AREA	STANDARD
PLEATED BLIND	STANDARD
LIVING UNIT SPEAKERS	STANDARD
FLOOR HATCH	STANDARD
TV HOLDER WITH EXTENSIBLE ARM	STANDARD
MAXI SLEEPING AREA WINDOWS	STANDARD
REINFORCED ABS SHOWER BASE + PLATFORM	STANDARD
HEATER	TRUMA COMBI 6
CP PLUS CONTROL	STANDARD
SOFT TOUCH ROOF	STANDARD
FOLDING TOP TABLE	STANDARD
CHAISE LONGUE PASSENGER SEAT	STANDARD
TWIN BEDS EXTENSION (64, 86)	STANDARD

EXTERIORS

2 PART XL DOOR + WINDOW	STANDARD
LIVING UNIT DOOR FLYSCREEN	STANDARD
CENTRAL LOCKING	STANDARD
EXTERIOR LIGHT	STANDARD
SKY DOME (P VERSION)	STANDARD
REAR BED ROOFLIGHT	70 x 50
REAR SKIRTS AND COLUMNS	ABS
HEATED TANK	STANDARD
OVERSIZED TANKS (clear/grey water)	120/110 litres
GARAGE LIGHTING	STANDARD
220 V GARAGE SOCKET	STANDARD
OPENABLE SKIRT WITH MAXI-GARAGE	STANDARD



CONFIGURATION OF CHASSIS AND HABITATION UNIT

CHASSIS CONFIGURATION



Standard equipment

	NEW K-YACHT TEKNO LINE	KROSSER	KEA P	KEA I
2.2 L 140 HP ENGINE (MANUAL)	Standard	Standard	Standard	Standard
BLACK FRONT GRILLE + HEADLIGHTS + SKID PLATE 	-- --	Standard	Standard	-- --
16" GLOSSY BLACK ALLOY RIMS	Standard	Standard	Standard	Standard
CLIMATE CONTROL SYSTEM	Automatic	Manual	Manual	Manual
STEERING WHEEL CONTROLS	Standard	Standard	Standard	Standard
TRACTION +/- HILL DESCENT	Standard	Standard	Standard	Standard
WHITE CAB COLOUR	-- --	Standard	Standard	-- --
ELECTRIC REARVIEW MIRRORS + DEFROSTER	-- --	Standard	Standard	-- --
FIX&GO	Standard	Standard	Standard	Standard
FOG LIGHTS	Standard	Standard	Standard	Standard
TPMS	Standard	Optional/Pack	Optional/Pack	Optional/Pack
LEATHER STEERING WHEEL AND GEARBOX	Standard	Optional/Pack	Optional/Pack	Optional/Pack
FULL DIGITAL CLUSTER	Standard	Optional/Pack	Optional/Pack	Optional/Pack
FULL LED FRONT LIGHTS	Standard	Optional/Pack	Optional/Pack	Optional/Pack

CHASSIS PACK



SPORT Pack

	NEW K-YACHT TEKNO LINE	KROSSER	KEA P	NEW KEA I
LEATHER COVERED STEERING WHEEL AND GEAR LEVER KNOB	standard	optional	optional	optional
TECHNO SILVER DASHBOARD	standard	optional	optional	optional
LED DAY RUNNING LIGHTS	-- --(*)	optional	optional	-- -- (*)
TPMS – TYRE PRESSURE MONITORING SYSTEM	standard	optional	optional	optional

NOT COMPATIBLE WITH THE SPORT PLUS PACK

(*) STANDARD EQUIPMENT FOR MOTORHOMES

SPORT PLUS pack

	NEW K-YACHT TEKNO LINE	KROSSER	KEA P	KEA I
LEATHER COVERED STEERING WHEEL AND GEAR LEVER KNOB	standard	optional	optional	optional
TECHNO SILVER DASHBOARD	standard	optional	optional	optional
LED DAY RUNNING LIGHTS	-- --(*)	optional	optional	-- -- (*)
TPMS – TYRE PRESSURE MONITORING SYSTEM	standard	optional	optional	optional
FULL LED HEADLIGHTS NEW	standard	optional	optional	optional

NOT COMPATIBLE WITH THE SPORT PACK

(*) STANDARD EQUIPMENT FOR MOTORHOMES



MATIC Pack

	K-YACHT TEKNO LINE	KROSSER	KEA P	KEA I
140 HP ENGINE	optional	optional (*)	optional	optional
AUTOMATIC TRANSMISSION	optional	optional (*)	optional	optional
16" GLOSSY BLACK ALLOY RIMS	optional	optional (*)	optional	optional
180 HP ENGINE	optional	optional (*)	optional	optional
AUTOMATIC TRANSMISSION	optional	optional (*)	optional	optional
16" GLOSSY BLACK ALLOY RIMS	optional	optional (*)	optional	optional

(*) COMPATIBLE WITH THE 3 SEAT VERSION OR INCREASED WEIGHT

SINGLE CHASSIS OPTION

OPTIONS UPDATE

	2024
2.2 L 180 HP ENGINE (MANUAL) 	<i>Optional</i>
RAIN / HEADLIGHT SENSOR	<i>Optional</i>
RADIO 2 DIN APPLE CAR PLAY/ ANDROID AUTO	<i>Optional</i>
ELECTRIC HANDBRAKE	<i>Optional</i>
TOTAL WEIGHT 3650 KG	<i>Optional</i>
TOTAL WEIGHT 4400 KG (HEAVY CHASSIS)	<i>Optional</i>
TOTAL WEIGHT 4500 KG (ALKO HEAVY CHASSIS)	<i>Optional</i>

NEW

Equipment **no longer available as a separate option**

LED DAY RUNNING LIGHTS
TPMS - TYRE PRESSURE SENSOR
TEKNO FINISH DASHBOARD
ELECTRIC HANDBRAKE
10" U-CONNECT RADIO
LEATHER COVERED STEERING WHEEL AND GEAR LEVER KNOB
WIRELESS CHARGER
AUTOMATIC CLIMATE CONTROL SYSTEM
FULL DIGITAL CLUSTER (DIGITAL DASHBOARD)

NEW

Out of production equipment, **no longer available**

220V CHARGING OUTLET ON CENTRAL PANEL
SAFETY PACK
ADVANCE SAFETY PACK
ELECTRIC FOLDING REARVIEW MIRRORS
PROGRAMMABLE WEBASTO HEATER
WEIGHT 4250 KG
RAIN / HEADLIGHT SENSOR

HABITATION UNIT PACKS



PREMIUM pack (*)

	K-YACHT TEKNO LINE	KROSSER	KEA P	KEA I
RADIO 2 DIN APPLE CAR PLAY/ ANDROID AUTO	optional	optional	optional	optional
DUAL FUNCTION REARVIEW CAMERA	optional	optional	optional	optional
120 W SOLAR PANEL (ADJUSTABLE)	optional	optional	optional	optional

(*) NOT COMPATIBLE WITH THE DIGITAL PACK



Pack EXTRA TECH

NEW

	K-YACHT TECKNO LINE	KROSSER	KEA P	KEA I
FULL DIGITAL CLUSTER	standard	optional	optional	optional
AUTOMATIC CLIMATE CONTROL SYSTEM	standard	optional	optional	optional
ELECTRIC HANDBRAKE	-- --	optional	optional	optional



OUTDOOR pack (*)



	K-YACHT TEKNO LINE	KROSSER	KEA P (*)	KEA I (*)
EXTERNAL GAS SOCKET	standard	-- --	optional	optional
EXTERNAL TV / 12 V / 220 V OUTLET	standard	-- --	optional	optional
EXTERNAL SPRAY (connection inside storage compartment)	standard	-- --	optional	optional

(*) IF THE ALDE OPTIONAL IS INSTALLED,
THE PACK IS COMPULSORY.

HABITATION UNIT PACKS



ENERGY pack

	 K-YACHT TEKNO LINE	 KROSSER	KEA P	KEA I
COMPRESSOR FRIDGE	-- -- (*)	-- -- (*)	optional	optional
LITHIUM BATTERY	-- --	-- --	optional	optional

(*) THE COMPRESSOR FRIDGE IS STANDARD ON THE 2024 RANGE



MEDIA Pack

	K-YACHT TEKNO LINE	 KROSSER	KEA P	KEA I
WI-FI ROUTER	optional	optional (*)	optional	optional
32" SMART TV	optional	optional (*)	-- --	-- --
24" SMART TV	-- --	-- --	optional	optional

(*) THE TV IS A 32" UNIT FOR THE 2024 RANGE

HABITATION UNIT PACKS



ARCTIC Pack

	K-YACHT TEKNO LINE	 KROSSER	KEA P	KEA I
TRUMA COMBI 6 E	<i>optional</i>	<i>optional</i>	---	---
DUO CONTROL GAS REGULATOR	<i>optional</i>	<i>optional</i>	---	---
HEATED WINDSCREEN	<i>optional</i>	---	---	---
EXTERNAL COVERS	<i>optional</i>	<i>optional</i>	---	---
INTERNAL DASHBOARD COVER	<i>optional</i>	<i>optional</i>	---	---

NOT COMPATIBLE WITH EXTRA WARM PACK OR ALDE OPTION

(*) CAB VEHICLE WINDSCREEN AVAILABLE AGAIN



EXTRA WARM pack

	K-YACHT TEKNO LINE	KROSSER	 KEA P	KEA I
TRUMA COMBI 6 E	---	---	<i>optional</i>	<i>optional</i>
DUO CONTROL GAS REGULATOR	---	---	<i>optional</i>	<i>optional</i>
HEATED FLOOR	---	---	<i>optional</i>	<i>optional</i>
HEATED WINDSCREEN	---	---	---	<i>optional</i>
INSULATED STEP	---	---	<i>optional</i>	<i>optional</i>
EXTERNAL COVERS	---	---	<i>optional</i>	<i>optional</i>
INTERNAL DASHBOARD COVER	---	---	<i>optional</i>	<i>optional</i>

NOT COMPATIBLE WITH ARCTIC WARM PACK OR ALDE OPTION

(*) CAB VEHICLE WINDSCREEN AVAILABLE AGAIN

AVAILABLE OPTIONS

ALDE heating

benefits

- Healthy atmosphere.
- Atmosphere free from suspended dust or feeling of dryness.
- Even and longer-lasting warmth.
- Quiet operation.
- No ventilation.
- Continuous production of hot water.

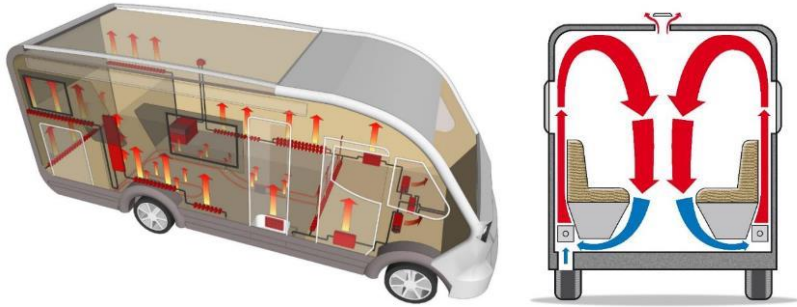

Engine heat exchanger as standard equipment

Energy can be saved with the heat exchanger. It uses the motorhome engine cooling system for heating and hot water production when driving.

Option available for K-Yacht Tekno Line and Kea ()*

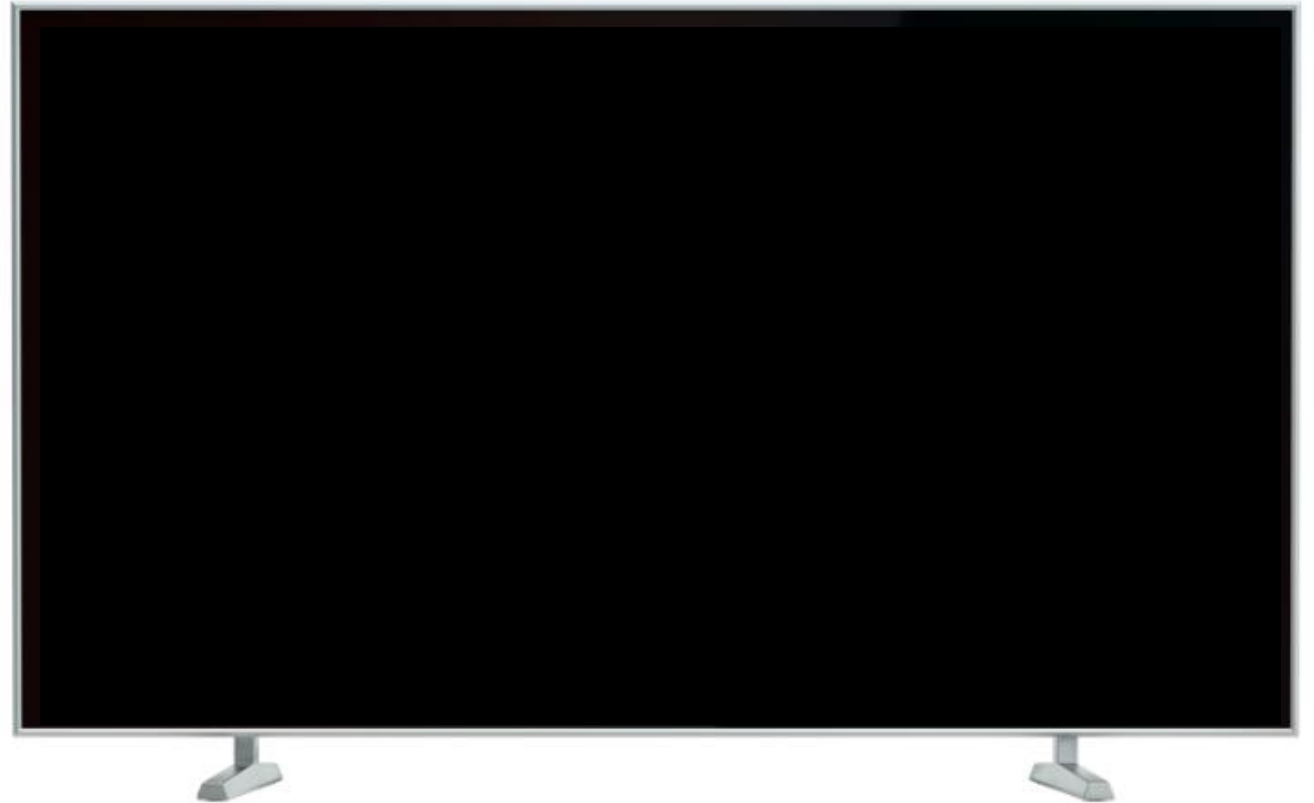

(*) IF ALDE OPTION IS INSTALLED, THE OUTDOOR PACK IS COMPULSORY.

V&N
Mobilvetta

2024 RANGE PLAN

VAN



Admiral

EURO 6-D

2.2 MULTIJET3 - 140 HP

MANUAL

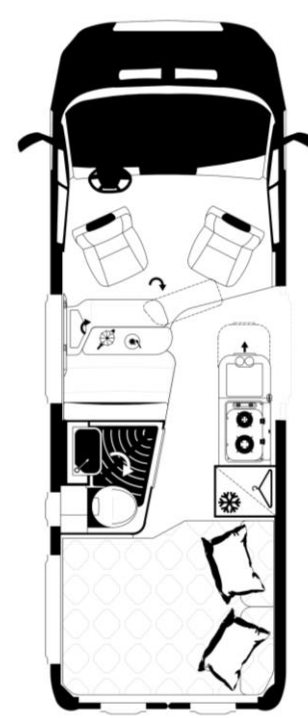

K 5.1

5.99 m

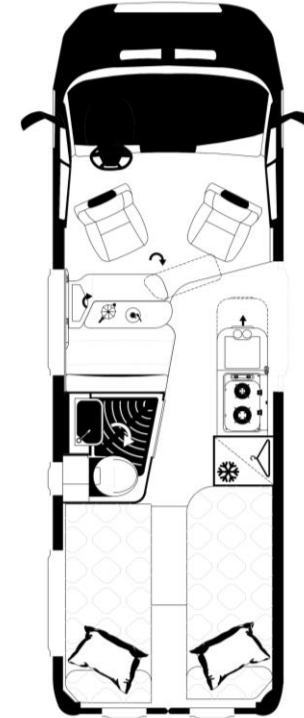

K 6.3

6.36 m

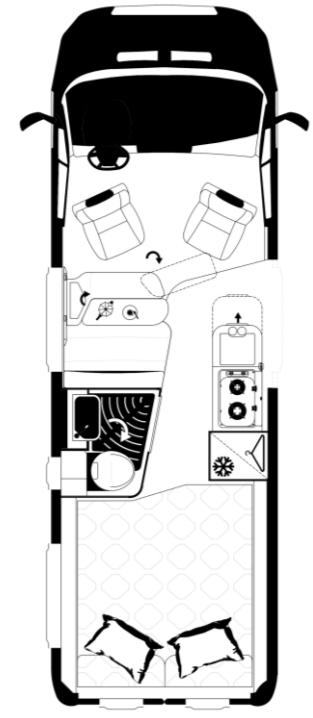

K 6.5

6.36 m

CHASSIS VERSION AVAILABILITY

Engines

	ADMIRAL K5.1		ADMIRAL K6.3		ADMIRAL K6.5	
	MANUAL	AUTOMATIC	MANUAL	AUTOMATIC	MANUAL	AUTOMATIC
140 HP / 35 t / light duty	<i>standard</i>	<i>optional</i>	<i>standard</i>	<i>optional</i>	<i>standard</i>	<i>optional</i>
180 HP / 35 t / light duty	<i>optional</i>	<i>optional</i>	<i>optional</i>	<i>optional</i>	<i>optional</i>	<i>Optional</i>
140 HP / 35 t / heavy duty	-- --	-- --	<i>optional</i>	<i>optional</i>	<i>optional</i>	<i>optional</i>
180 HP / 35 t / heavy duty	-- --	<i>optional</i>	-- --	<i>optional</i>	-- --	<i>optional</i>



2.2 L 160 HP ENGINE



**NEW FEATURES
FOR SEASON 2024**

COMMON NEW FEATURES

POP-UP roof

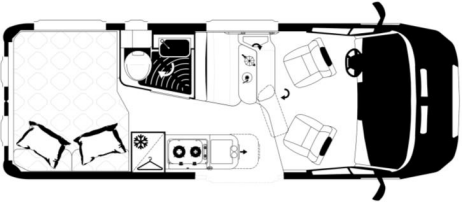
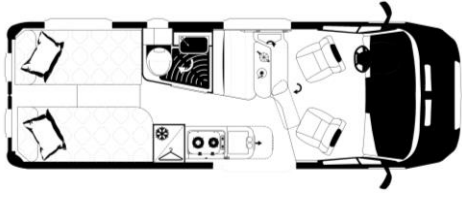
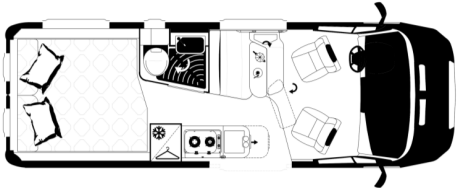
	MODEL	COLOUR	POP-UP roof
 <p>5.99 m</p>	K 5.1	BLACK	Option available
 <p>6.36 m</p>	K 6.3	BLACK	Option available <u>only with 3 homologated seats</u> NEW
 <p>6.36 m</p>	K 6.5	BLACK	Option available <u>only with 3 homologated seats</u> NEW

COMMON NEW FEATURES

Openable panoramic roof

Open point: Can it be kept open while driving?



Improved air circulation

The panoramic roof opens up on one side at the top.
It opens partially.
It is fitted with a high strength gasket.

Combines with the pop-up roof.

Elegant, automotive style design

Tested for draughts.

Tested with a 2 bar air jet around the entire perimeter of the panoramic roof and combined pop-up roof.
No openings or holes allow draughts to penetrate internally.
Next step: check the tightness of the panoramic roof on rough roads

WINTER PACK

Standard on the entire range

**INSULATED GREY WATER TANKS WITH
ANTI-FREEZING THERMOSTAT SENSOR**



COMMON NEW FEATURES

Expansion tank



Water and electricity saving



The expansion tank eliminates the intermittent functioning of pumps with pressure switch and supplies a constant flow of water as requested. It therefore reduces the overall water consumption.

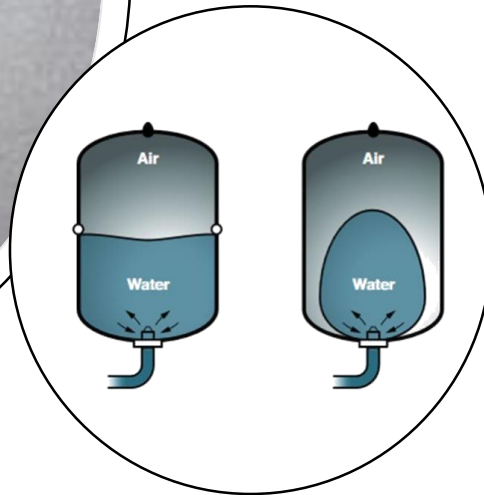

Long life ...



for the pump and the boiler, along with a more efficient functioning. The internal membrane absorbs hammering and ensures a smooth flow of water.

LE NOVITA' COMUNI

Nuova radio optional

Caratteristiche:

Schermo 9" touch, schermo FLAT capacitivo, illuminazione RGB, schermata di avvio personalizzabile, ingresso retrocamera, ingressi USB & AUX, output video, compatibilità con comandi al volante, Apple CarPlay (USB/WiFi), Google Android Auto (USB/WiFi), Radio FM RDS / DAB+, Bluetooth (HFP/Audio), 4 x 50 W,, EQ 13 bande, 3 RCA, filtro audio e allineamento temporale.

Non serve più il cavo 

per connettere lo smartphone alla radio! AndroidAuto e AppleCarPlay funzionano anche tramite semplice collegamento wireless.

Si adatta alle condizioni di luce ...

o alle preferenze dell'utente. Gestione di finestre multiple completamente personalizzabile trascinando e ingrandendo o rimpicciolendo a piacere i contorni delle finestre.

Con la retrocamera... 

In caso di retrocamera doppia funzione parcheggio/viaggio, si possono ovviamente ricevere sulla radio entrambi i segnali, ed è possibile switchare dall'uno all'altro tramite un semplice tasto.

Tutto schermo o doppia visualizzazione 

In maniera totalmente innovativa, si possono visualizzare contemporaneamente sullo schermo le APP e le funzioni di AndroidAuto / Apple CarPlay e la RADIO AM/FM/DAB.

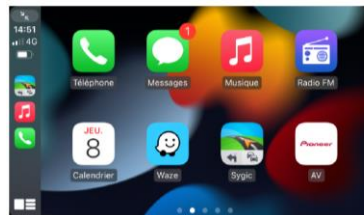



2024 RANGE





INTERIORS: NEW FEATURES FOR THE KITCHEN

Wall unit doors



Better internal ergonomics.

Increased clearance and space for movement in front of the kitchen with the door is open.

Unchanged style and appeal.

The new solution perfectly fits into Admiral interior design

No loss of storage space.

The smaller door does not affect the unit's storage capacity. The bottom section of the door turns into a handy shelf for small objects.

The change will be introduced early in 2023

INTERIORS: NEW FEATURES FOR THE KITCHEN

Pull-out basket



A more robust pull-out basket design

A new design and more robust rails for the pull-out side basket makes the unit stronger and more stable and ensures a long-lasting use



HOW IT WAS

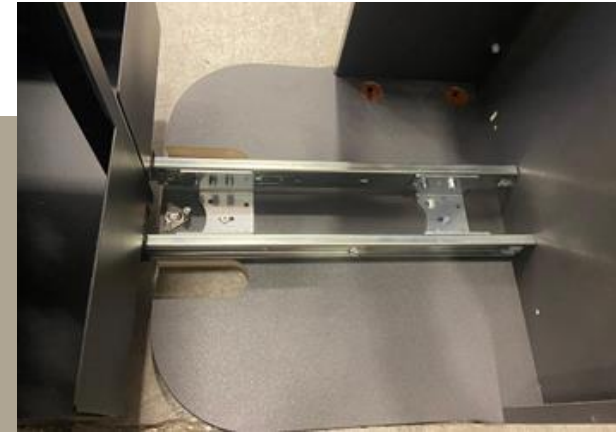

UPHOLSTERY

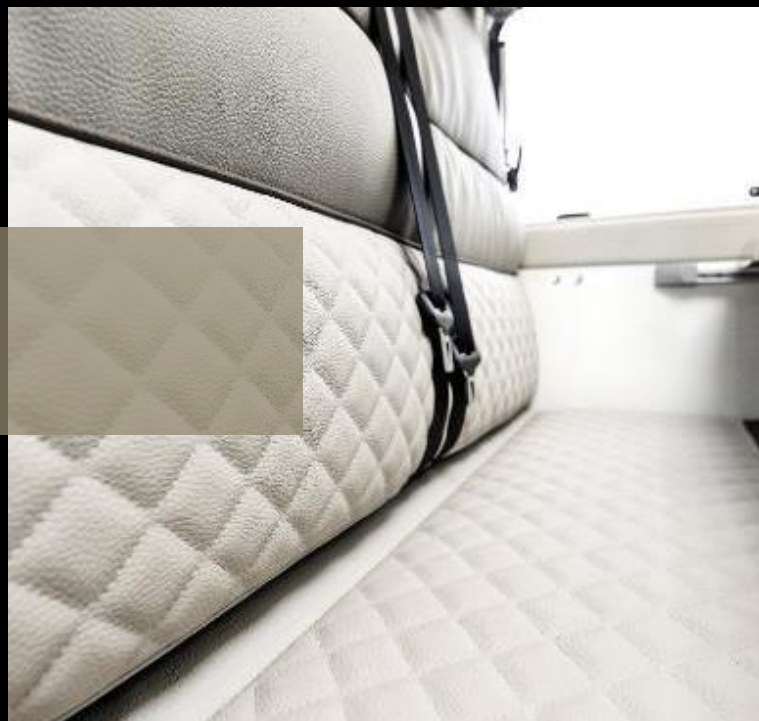

COMFORT GREY

Standard, eco-leather.



SUPREME

Optional, eco-leather.

ADMIRAL

WHITE
SOLID colour
Standard



LANZAROTE GREY

SPECIAL SOLID colour
Optional



EXPEDITION GREY

SPECIAL SOLID colour
Optional



EXTERIOR COLOURS

BLACK

METALLIC colour
Optional



IRON GREY

METALLIC colour
Optional



ADMIRAL

Standard equipment

CHASSIS

POWER UNIT	140 HP
MANUAL CLIMATE CONTROL SYSTEM	STANDARD
DRIVER + PASSENGER AIR BAG	STANDARD
ESC, TRACTION+, HILL CONTROL	STANDARD
CRUISE CONTROL	STANDARD
DAB RADIO PROVISION	STANDARD
16" WHEELS, BLACK ALLOY RIMS	STANDARD
BLACK GRILLE, FRONT GRILLE, SKID PLATE AND HEADLIGHT FRAME	STANDARD
DIESEL TANK 90 litres	STANDARD
AUTOMOTIVE STYLE REAR WINDOWS	STANDARD
SEAT COVERS	STANDARD
BUILT-IN WINDOW	STANDARD
ELECTRICAL SOCKET SHOWER CONNECTION (no K 5.1)	STANDARD
DRIVER'S SIDE WINDOW	STANDARD
EXTERIOR LIGHT	STANDARD

LIVING AREA

ALL IN ONE FABRIC-COVERED PANEL INCORPORATING THE PANORAMIC ROOF AND ROOFLIGHT, WITH LED LAMP	STAND ARD
SOFT TOUCH WALLS	STAND ARD
USB SOCKETS	STAND ARD
HATCH AND STOWAGE IN THE DOUBLE FLOORING	STAND ARD
CAST ACRYLIC STONE TOP AND INTEGRATED SINK	STAND ARD
REFRIGERATOR 84 LITRES (135 L REFRIGERATOR AVAILABLE AS AN OPTION)	STAND ARD
PULL-OUT BASKET WITH STAINLESS STEEL SHELVES AND BOTTLE RACK.	STAND ARD

WINTER PACK

INSULATED GREY WATER TANKS WITH ANTI-FREEZING PROBE	STANDA RD
--	--------------

SLEEPING AREA AND GARAGE

MEMORY FOAM MATTRESSES. 3D BED BASE SYSTEM. BED INSULATED FROM THE GARAGE	STANDARD
RADIO SPEAKERS	STANDARD
SOFT TOUCH WALLS	STANDARD
TOILET WITH XL SEPARATE ROOMS, WINDOW	STANDARD
GARAGE: ALUMINIUM COVER AND RAMP	STANDARD

GRAND TOUR

OPENABLE PANORAMIC ROOF	STANDARD
REAR-VIEW CAMERA	STANDARD
RADIO CONTROLS ON THE STEERING WHEEL	STANDARD
CAB PLEATED BLIND	STANDARD
ENTRANCE DOOR FLYSCREEN	STANDARD
DASHBOARD ALUMINIUM FINISH	STANDARD



PACKS AND OPTIONS

AVAILABLE PACKS



DRIVE Pack

	ADMIRAL
LED DAY RUNNING LIGHTS	<i>optional</i>
FOG LIGHTS	<i>optional</i>
LEATHER COVERED STEERING WHEEL AND GEAR LEVER KNOB	<i>optional</i>



TRAVEL Pack

	ADMIRAL
AWNING	<i>optional</i>
SOLAR PANEL	<i>optional</i>



ARCTIC pack

	ADMIRAL
COMBI D6E DIESEL AND CP PLUS HEATER	<i>optional</i>
CAB THERMAL INSULATION	<i>optional</i>
CAB THERMAL BLIND	<i>optional</i>
PLEATED CURTAINS IN CAB AND REAR DOORS	<i>optional</i>
THERMAL INSULATING COVERS FOR WINDOWS	<i>optional</i>



LITHIUM Pack

	ADMIRAL
DEDICATED ELECTRICAL SYSTEM	<i>optional</i>
DEDICATED LITHIUM BATTERY CHARGER	<i>optional</i>
SPECIAL CONTROL UNIT	<i>optional</i>
LITHIUM BATTERY (100 Ah)	<i>optional</i>

SAFETY pack ADVANCE

	ADMIRAL
ADAPTIVE CRUISE CONTROL	<i>optional</i>
FULL BRAKE CONTROL	<i>optional</i>
RAIN SENSOR	<i>optional</i>
LDWS (Lane Departure Warning System)	<i>optional</i>
HBR (High-Beam Recognition)	<i>optional</i>
TSR (Traffic Sign Recognition)	<i>optional</i>

AVAILABLE OPTIONS



Transverse bed kit. 

For a more comfortable bed in the dinette.
1880 x 600/500 mm

Folding, single-piece construction. 

Stable and easy to assemble. 

With bed bag included. 

AVAILABLE OPTIONS



Supplementary furniture kit.

For more storage space at the rear of the vehicle.

An adaptable, versatile garage.

Available options:

Free compartment installed in the double floor and reduced bed height.

Double floor and more restricted storage space

Full height cabinet with large storage capacity

Easy to install.



Mobilvetta
M

THANK YOU